

General Features

A glass level gauge is an instrument suitable to give a direct level reading of a fluid contained in a vessel.

Reflex type is used in HLC-90 Level Indicator.

There are prismatic grooves on the reflex glass.

Liquids and Gases behind the reflex glass in the level indicator; Breaks the light at a different angle.

Thus, The Water and Steam appears in different brightness through pass.

The Liquids appears darker because of absorption of light.

The Steam appears brighter or white due to reflection of glass.

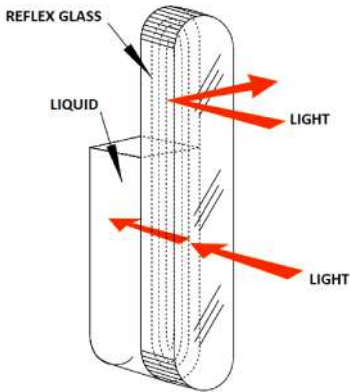

Advantages

- It has high mechanical strength.
- It is long lasting.
- Direct level reading.
- Low cost.

Applications

- Petrol Refineries , Oil and Gas Industries.
- Pharmaceutical, Chemistry, Textile and Paper Industries
- Shipyards.
- Boilers and Tanks.



Technical Features

- There are two on-off and one drain valves.
- It has mono body and valves with flange connection.
- The Flange standard in EN1092-1/11 PN16 DN20.

TESTING PRESSURE	PN 32 kg/cm ²
WORKING PRESSURE	PN 16 kg/cm ²
MAX. TEMPERATURE	T=250°C

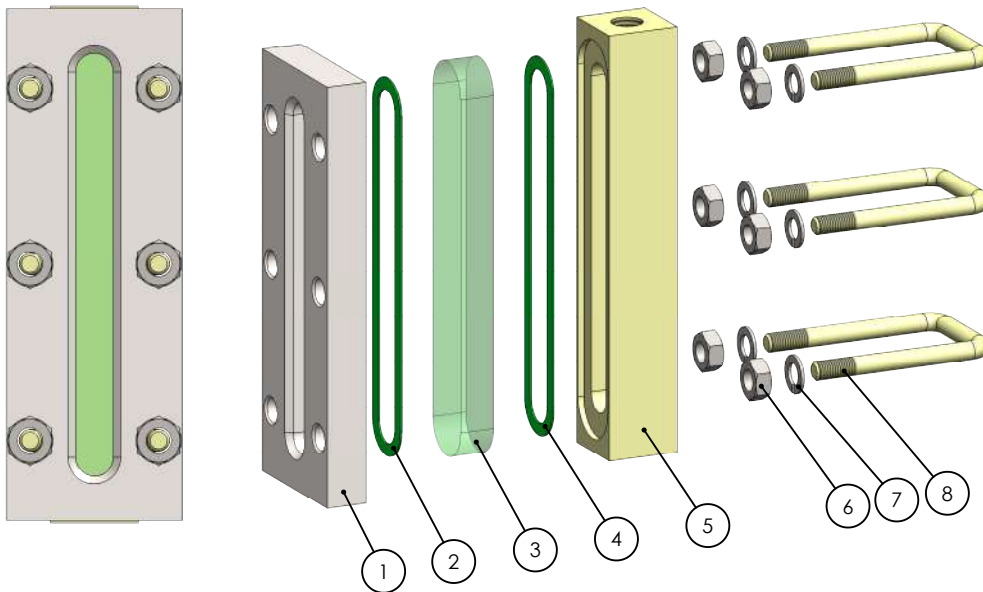

NO	PART DESCRIPTION	MATERIAL
1	COVER	ST37-2
2	CUSHION GASKET	GRAPHITE
3	REFLEX GLASS	BOROSILICAT
4	SEAL GASKET	GRAPHITE
5	BODY	ST37-2
6	NUT	8.8
7	WASHER	8.8
8	U BOLT	8.8

TECHNICAL DIMENSIONS

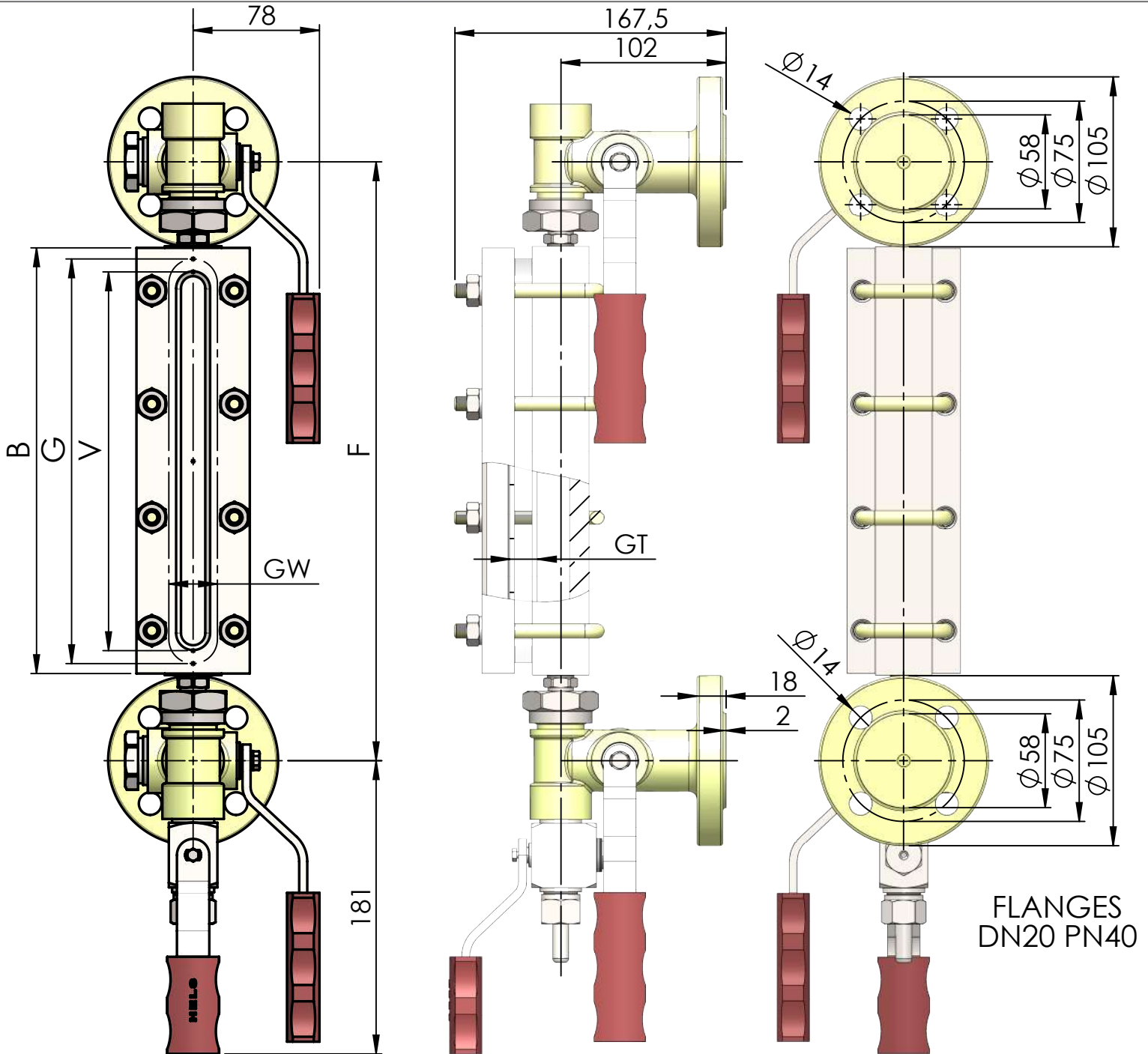

HLC - 90 REFLEX GLASS LEVEL GAUGE						
DISTANCE BETWEEN FLANGES	BODY LENGTH	VISIBLE LENGTH	GLASS LENGTH	GLASS WIDTH		WEIGHT (kg)
				GLASS THICKNESS	GW x GT	
F	B	V	G	GT	GW x GT	
310	205	168	190	30 x 17	30 x 17	9,3
340	235	198	220	30 x 17	30 x 17	10
370	265	228	250	30 x 17	30 x 17	10,4
400	295	258	280	30 x 17	30 x 17	10,9
440	335	298	320	30 x 17	30 x 17	12
500	395	358	190	30 x 17	30 x 17	12,7
515	410	373	190	30 x 17	30 x 17	13
575	470	433	220	30 x 17	30 x 17	
635	530	493	250	30 x 17	30 x 17	
695	590	553	280	30 x 17	30 x 17	
775	670	633	320	30 x 17	30 x 17	
900	795	758	250	30 x 17	30 x 17	
990	885	848	280	30 x 17	30 x 17	
1110	1005	968	320	30 x 17	30 x 17	
1285	1180	1143	280	30 x 17	30 x 17	
1445	1340	1303	320	30 x 17	30 x 17	
1580	1475	1438	280	30 x 17	30 x 17	
1780	1675	1638	320	30 x 17	30 x 17	
2115	2010	1973	320	30 x 17	30 x 17	

PART LIST

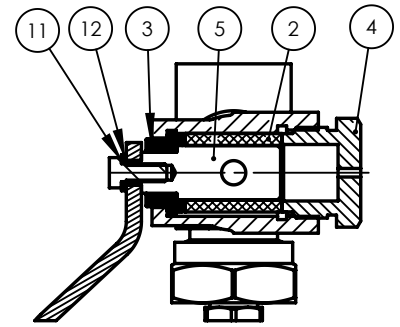
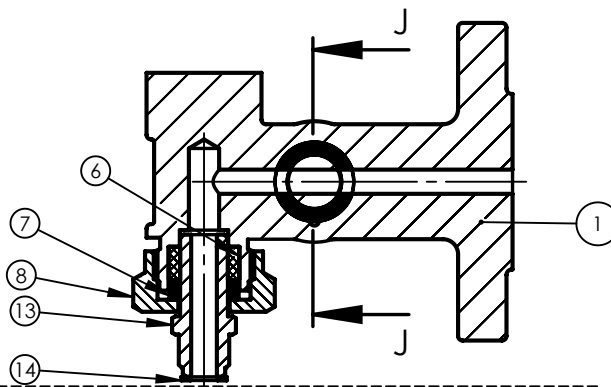
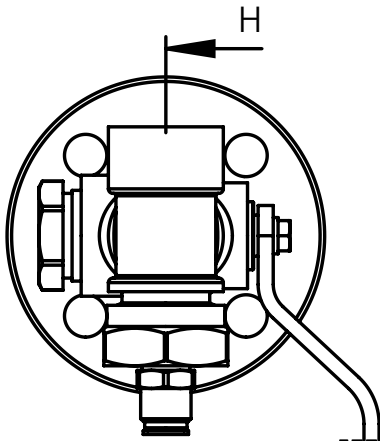

SECTION J-J
SCALE 1 : 2.5

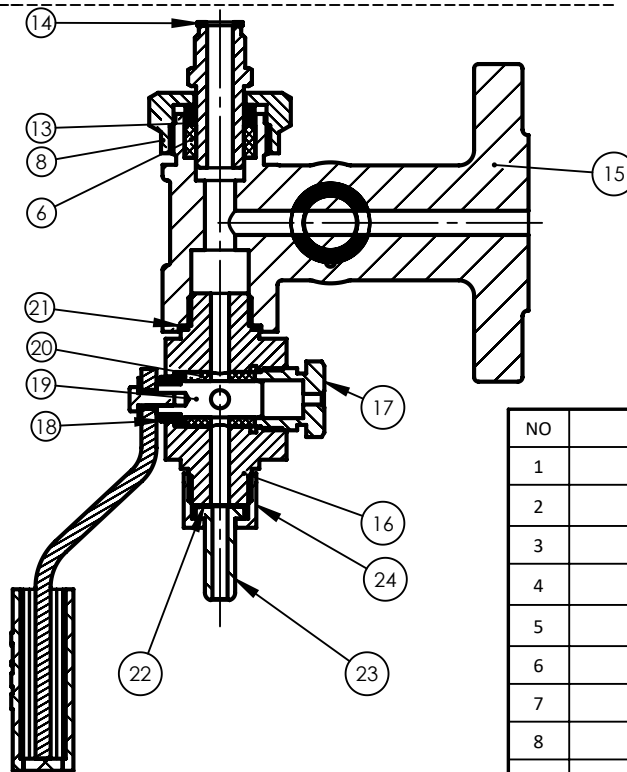
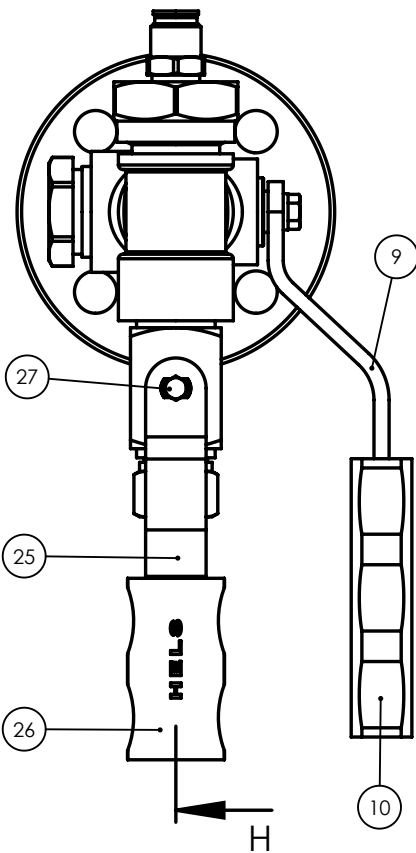

SECTION H-H
SCALE 1 : 2.5

NO	PART DESCRIPTION	MATERIAL
1	UPPER VALVE BODY	GGG40,3
2	VALVE PLUG SEAL RING	GRAPHITE
3	SPLIT RING	ST37
4	VALVE PLUG UNION NUT	ST37
5	VALVE PLUG	AISI 304
6	SEAL RING	GRAPHITE
7	TRUST RING	ST37
8	ADAPTOR UNION NUT	ST37
9	HANDLE	ST37
10	HANDLE COVER	ABS
11	BOLT ; DIN934	AISI 304
12	WASHER ; DIN 127	AISI 304
13	ADAPTOR	AISI 304
14	ADAPTOR SEAL WASHER	AISI 304
15	INNER VALVE BODY	GGG40,3
16	DRAIN VALVE BODY	ST37
17	DRAIN VALVE TIGHTNING NUT	ST37
18	DRAIN VALVE THRUST RING	ST37
19	DRAIN VALVE PLUG	AISI 304
20	DRAIN PLUG SEAL RING	GRAPHITE
21	DRAIN VALVE SEALING WASHER	AISI 304
22	DRAIN PIPE SEALING WASHER	AISI 304
23	DRAIN PIPE	ST37
24	DRAIN PIPE NUT	ST37
25	DRAIN VALVE HANDLE	ST37
26	DRAIN VALVE HANDLE COVER	ABS
27	BOLT ; DIN937	AISI 304