

SPRING RETURN ELECTRIC LINEAR ACTUATOR FOR EMERGENCY (POWER-FAILURE)

(GEA-10SR)



GENERAL

- Designed and developed for emergency (Power-failure).
- Valve is closed automatically by build-in spring in case of the electric power- failure.
- Synchronous motor with reduction gear generating variable force and speed
- Minimized maintenance due to the robust body and reliable operating
- Applied into Steam, HVAC or Humidification System

TYPE SUMMARY

- The supplying electric power : 24VAC or 220VAC
- Control signal : 0~10VDC, 2~10VDC or 4~20mA

Model	Spring Return Action (In case of Power-failure)	Description
GEA-10SR(D)	Stem is moving down to close valve	Push-down-to-close
GEA-10SR(U)	Stem is moving up to close valve	Push-up-to-close

APPLICATION

- The GEA-10SR actuator is made for the control of 2-way & 3-way globe valves(15A ~ 50A) used in HVAC system that require a "fail-safe" spring-return function.

Valve	Type	GVS, GXS, GVF, GXF
2-way	Single Seat	10K, 16K, 20K
3-way	Mixing	10K

(GVS, GXS belong to the products of GINICE)

TECHNICAL DATA



Model	GEA-10SR	
OPERATING POWER (V)	24V AC $\pm 10\%$	220V AC $\pm 10\%$
FREQUENCY (Hz)	60 (50)	60 (50)
NOMINAL SPRING FORCE N(KN)	1000 (1.0)	1000 (1.0)
NOMINAL STROKE (mm)	20	20
OPERATING TIME (Sec)	75 sec(0.27mm/sec)	
SPRING RETURN TIME	Approx. 3 sec	
REGULAR LOAD (A)	1.33 (1.55)	0.13 (0.16)
CONDENSER (μF)	50	0.8
POWER CONSUMPTION (VA)	54(61)	40(49)
INPUT SIGNAL	0~10V, 2~10V, 4~20mA	0~10V, 2~10V, 4~20mA
OUTPUT SIGNAL	Same signal as input	
MANUAL OVERRIDE	N/A	
AMBIENT TEMPERATURE	Operation : -15 ~ 70°C / Transportation : -40 ~ 80°C	
MOTOR INSULATION CLASS	E (IEC)	
HUMIDITY	5 ~ 95% Rh	
HOUSING PROTECTION GRADE	IP 54 (DIN4050)	
CABLE ENTRIES	PF $\frac{1}{2}$ \times 1EA , PF $\frac{3}{8}$ \times 1EA	
WEIGHT (Kg)	7.0(Kg)	

TECHNICAL FEATURES

- Built-in torque switch to protect valve and actuator when overload.
- Automatic set(0-100%) by auto setting system and the adjustment of stroke is allowable.
- Selectable NC/NO without any special tools.
- Valve is closed automatically in case of electric power-failure.

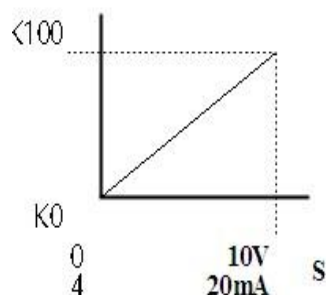

K0 : flow rate 0%

K100 : flow rate 100%

S : Signal (0~10V, 2~10V, 4~20mA d.c)

MOUNTING & INSTALLATION GUIDE

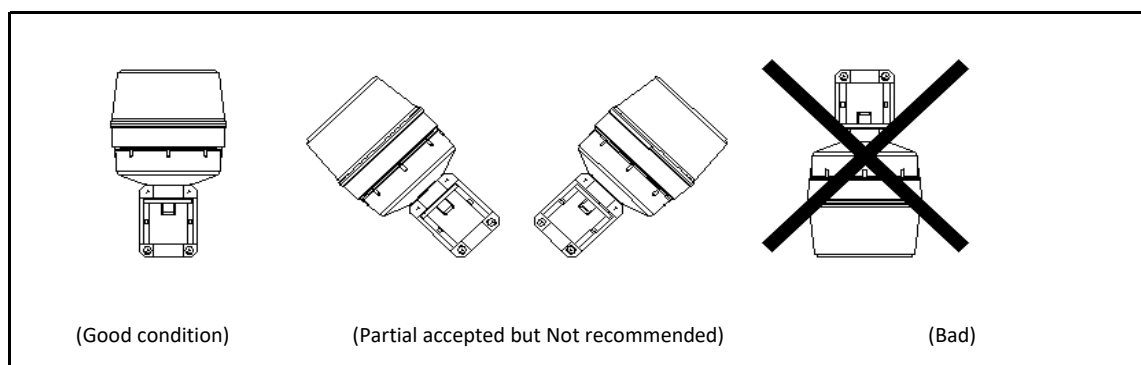

COMMISSIONING



Before commissioning, check wiring and specification first and then, test.

- Stem down(moving toward to valve) : Valve closed (D-type)
- Stem up(moving toward to actuator) : Valve closed (U-type)

WIRING DIAGRAM

GEA-10SR 24VAC

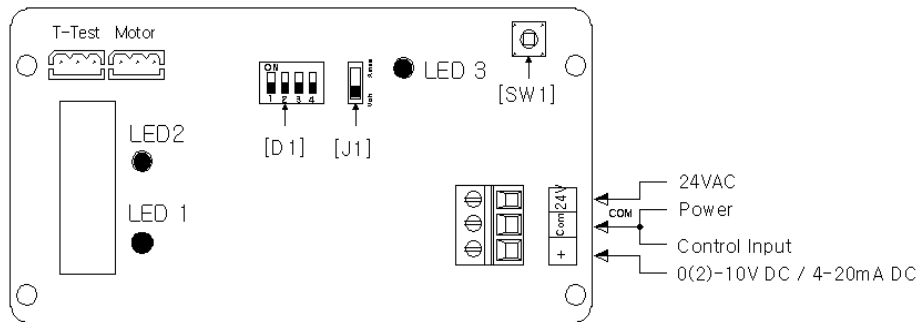

GEA-10SR 24VAC W/Output

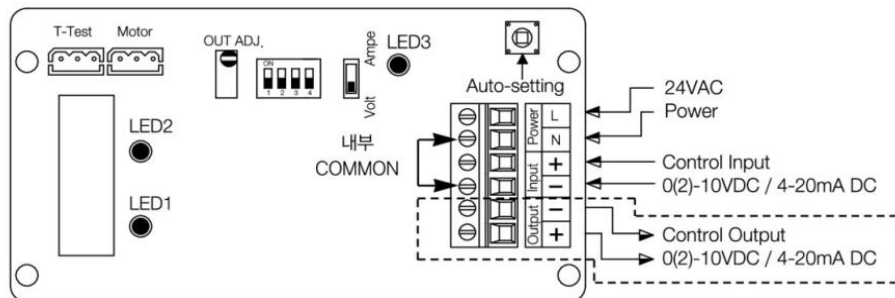

GEA-10SR 220VAC

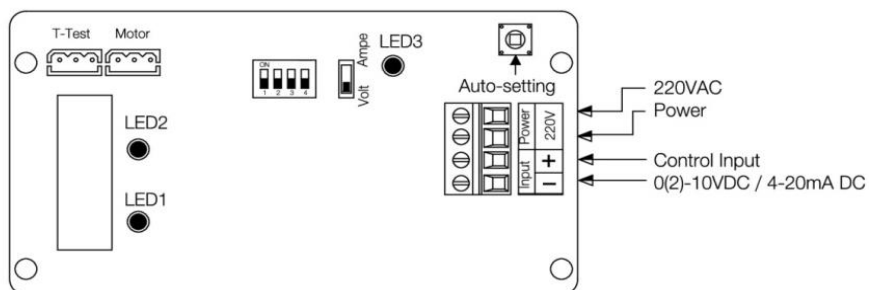

GEA-10SR 220VAC W/Output

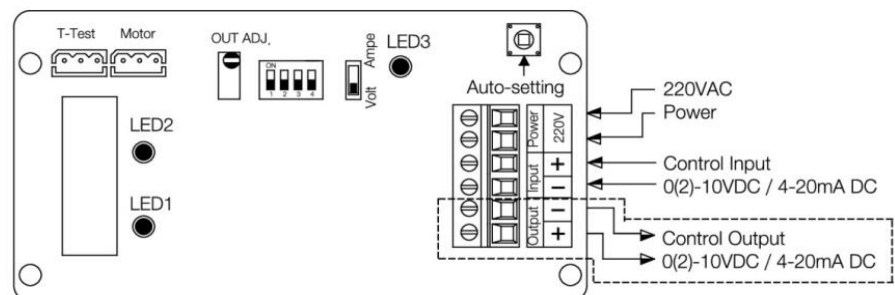

DIMENSION

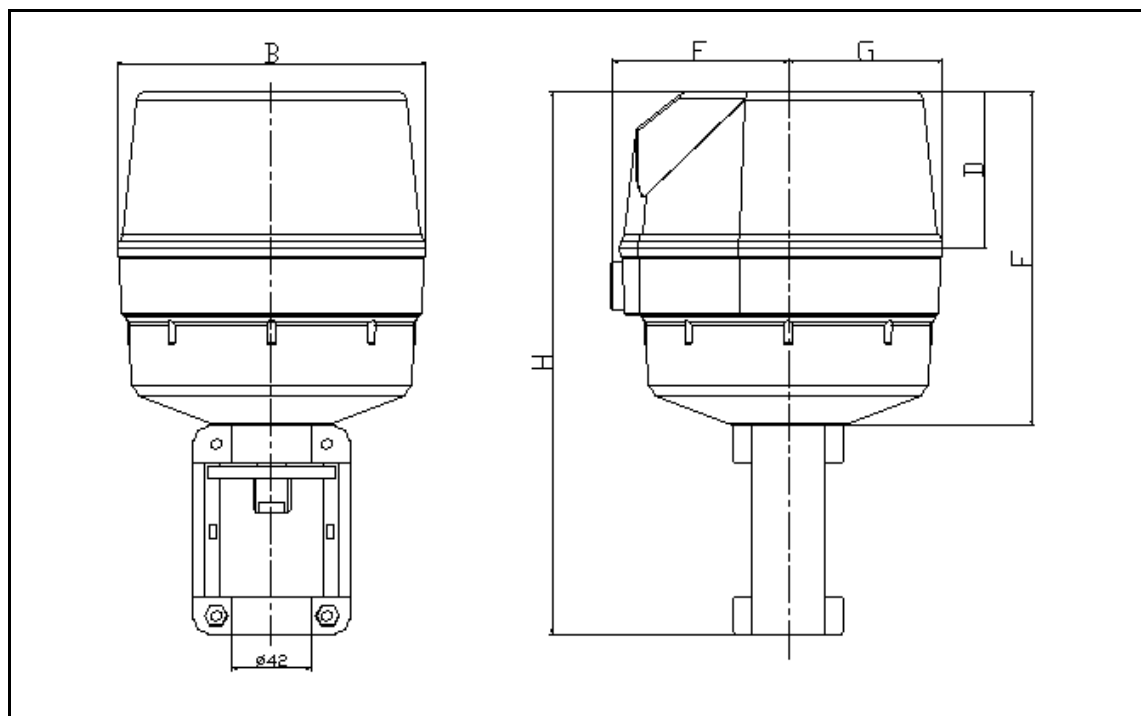

(Unit : MM)

Model	GEA-10SR
B	166
H	288
D	83
F	178
E	94
G	310
N	79

GINICE CO., Ltd.

GINICE Bldg., (Chuneui-Dong) Bucheon-ro, 186beon-gil, Wonmi-gu, Bucheon-City,
Gyeonggi-do, Korea. 420-857

TEL : +82-32-666-9946 | FAX : +82-32-666-9949

E-mail : ginicegood@ginice.co.kr / www.ginice.com

GINICE FACTORY

92, Yulsaengjungang-ro 206beon-gil, Daegot-myeon, Gimpo-si, Gyeonggi-do, Korea

We reserve the right to change or modify specifications, features, options, dimensions, or materials without prior notice.